

PMR.africa has completed its annual national survey on Architects in South Africa.

The respondents rated the architects across a range of 15 attributes, namely:

- Ability to administer the contract
- Black Economic Empowerment (BEE)
- Commitment to work within the budget
- Communicates design and management skills
- Competitive pricing
- Cooperation with client
- Creativity
- Ethical business practices
- Innovation
- On-time delivery of information
- Quality control
- Quality of construction documentation
- Reputation
(i.e. perception of the firm's brand, integrity, CSI)
- Responsiveness
- Sustainable development practices

The ratings are based on the perceptions of the respondents.

The results are categorized according to the number of associates/directors/partners per firm, namely:

- large architect firms = 10+ associates/directors/partners
- medium-sized architect firms = 4 – 9 associates/directors/partners
- small architect firms = 2 – 3 associates/directors/partners.

Large Architect Firms

	MEAN SCORE
BOOGERTMAN + PARTNERS ARCHITECTS	4.25
MDS Architecture	4.16
Bentel Associates International (Pty) Ltd	4.00
tja ARCHITECTS	3.90
SVA International (Stauch Vorster Architects)	3.87
LYT Architecture	3.80

Medium-Sized Architect Firms

	MEAN SCORE
TCRPV ARCHITECTS	4.34
Gass Architecture Studios	4.15
GLH Associates Architects	4.07
BSM Architects	4.00
Arc Architects	3.95
KMH Architects	3.90
Osmond Lange Architects & Planners	3.88
DHK Architects	3.83
DBM Architects JHB	3.77
Paragon Architects	3.75
FWJK Architecture	3.68

Small Architect Firms

	MEAN SCORE
MBK Architects	4.10
Impendulo Design Architects	4.07
Batley Partners International	3.93
Smith Architects	3.87
Jakupa Architects	3.80
StudiosMAS Architecture & Urban Design	3.75
Studio 88 Architects	3.70

How the survey was conducted:

Universe: Construction industry.

Timing: Interviews were conducted from November 2025 to January 2026.

Sample: Random national sample of 140 respondents comprising 6 architects (peers), 20 representatives of construction companies, 52 consulting engineers, 17 developers and 45 quantity surveyors.

Methodology: Interviews were carried out telephonically utilising semi-structured questionnaires. Back-checks were conducted at all stages of the fieldwork, data capture and analysis stages.

Business Intelligence Research Report:

A detailed business intelligence research report providing competitive insight of strategic value is available. The report includes comparative tables and graphs of all the firms rated, verbatim comments as well as demographic details delivered in digital format with a PowerPoint presentation. The research report is available at R 31 922 excl. VAT. Sections of the report are available.

Architect Firms: Profile – Boogertman + Partners

For more than four decades, Boogertman + Partners has honed an approach to architecture that delivers lasting value for clients and for the people and communities who experience the spaces we design. Our philosophy is rooted in a distinctive human-centred, contextually responsive and sustainable approach to design, underpinned by a collaborative ethos and a culture of conceptual innovation.

"I would like to congratulate all the teams in our practice on this achievement. It is deeply meaningful to us that our work and the services we offer are valued by our clients and peers, and we thank them for their vote of confidence," says Boogertman + Partners director Bob van Bebber. "I believe that this recognition begins with mutual respect. One of our core beliefs is that the most meaningful and innovative architecture is realised through a pro-cess of collaboration and co-creation. We find it hugely encouraging that awards like the PMR Diamond Arrow Award affirm this approach."

As a partner-led practice, Boogertman + Partners works across a diverse range of sectors, including



WAICA Reinsurance Corporate West Africa Regional Office in Accra, Ghana



Discovery Place

commercial, residential, hospitality, healthcare, retail, education, industrial and mixed-use developments. Our studios also include dedicated in-house expertise in interior design, landscape design, urban design and graphic design, offering a cohesive approach with multiple disciplines co-ordinated under one roof. We deliver projects at scale across South Africa, the African continent, and internationally.

Boogertman + Partners' partner-led structure has all the advantages of boutique specialist teams with the capacity to collaborate at scale. This collective capability allows us to pursue design excellence and innovation, even on large and complex projects.

"We are guided by the principle of human-centred design," says van Bebber. "Put simply: we design for people. Human-centred design contributes to built environments that are more inclusive, resilient and enduring, and ultimately benefits our clients and their users alike. We believe that architecture, at its best, has the power to make everyday life better."

This philosophy has shaped projects ranging from beloved national icons such as Soccer City and urban

landmarks like Discovery Place to exciting large-scale projects elsewhere on the continent, including the new WAICA Reinsurance Corporation West Africa Regional Office in Accra, Ghana, currently under construction, and God's Window Skywalk, which recently broke ground. At the same time, we embrace the opportunity to use our experience and expertise on small-scale and temporary cultural projects, such as the central lounge at the RMB Latitudes Art Fair, which we are designing for a second time in 2026.

Boogertman + Partners brings the same commitment and care to every project we design across all scales and contexts.

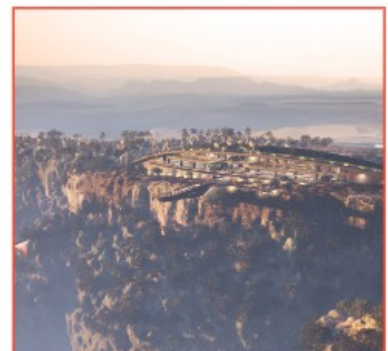

God's Window Skywalk